

ICBCW24/S

FEATURES

Gentle heat warms cups, dishes

Removable non-slip mat

Push to open

Black glass and stainless steel options

Hidden interior control panel

23 kg capacity - room for 40 cups!

Rigorously tested in our U.S. manufacturing facilities for decades of use

Exceptional support from our Customer Care team



PRODUCT SPECIFICATIONS

Model	ICBCW24/S
Dimensions	597mmW x 140mmH x 533mmD
Capacity	23 L
Weight	36 kg
Electrical Supply	120 VAC, 60 Hz
Electrical Service	550 W
Receptacle	3 prong ground type

ELECTRICAL

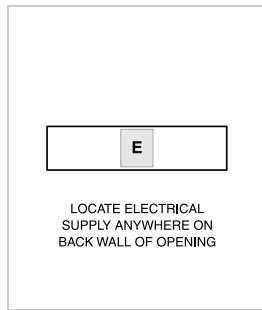

NOTE: Dimensions in parenthesis are in millimeters unless otherwise specified

DIMENSIONS

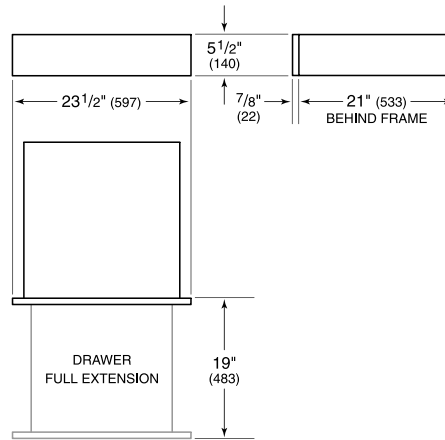

FLUSH INSTALLATION

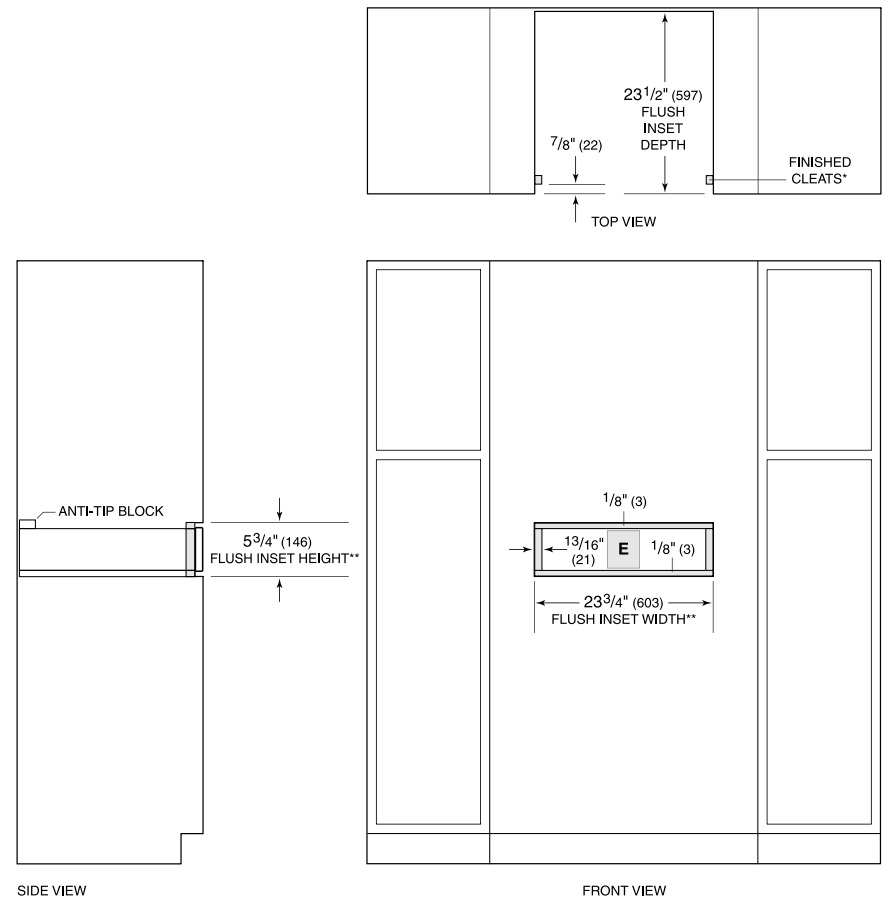

*Will be visible and should be finished to match cabinetry.
 **Dimension provides minimum reveals.